

Product Sheet

1 BAY CURVED LEG SWING

1 BELT SEAT, 2 TODDLER
CLS1D



**Critical
Fall Height**
1.4m



**Total
Height**
2.4m



**Recommended
Surfacing**
26m²



**Recommended
Age**
All Ages



**Recommended
Users**
1-2



NZS 5828:2015

STEEL FINISH

- 1. Galvanised
- 2. Powdercoated

PARK SUPPLIES & PLAYGROUNDS

PO Box 59017
Mangere Bridge 2151
PH: 0800 752 947
PH: 09 527 4666
EM: SALES@PARKSUPPLIES.CO.NZ
W: www.parksupplies.co.nz

COPYRIGHT NOTICE:

Any copying (including photocopying or electronic storage) of any part of this document without prior written consent from Park Supplies & Playgrounds is an infringement of copyright.
NOTE: Our company is continually refining and improving our products. We reserve the right to alter/modify any of our products design without prior notice. CAD drawings are INDICATIVE ONLY.
Activities are designed and manufactured in accordance with the NZS5828:2015



Product Sheet

1 BAY CURVED LEG SWING

1 BELT SEAT, 2 TODDLER
CLS1D

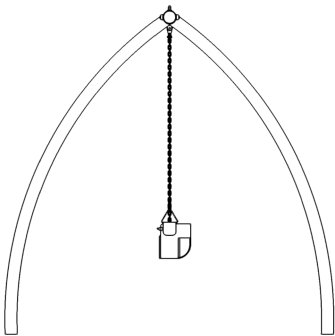
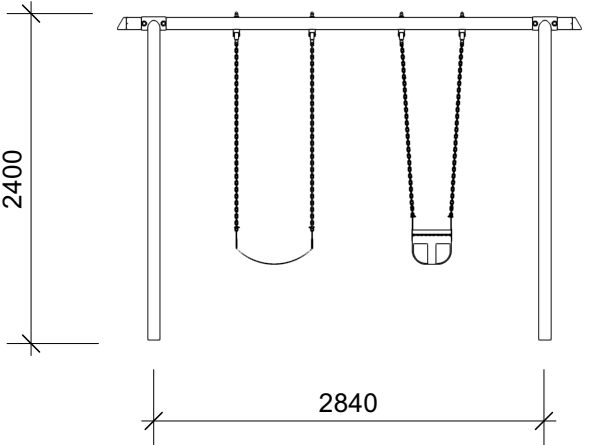
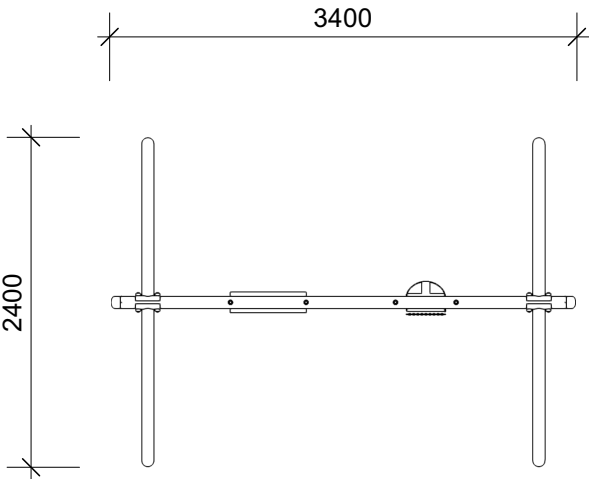
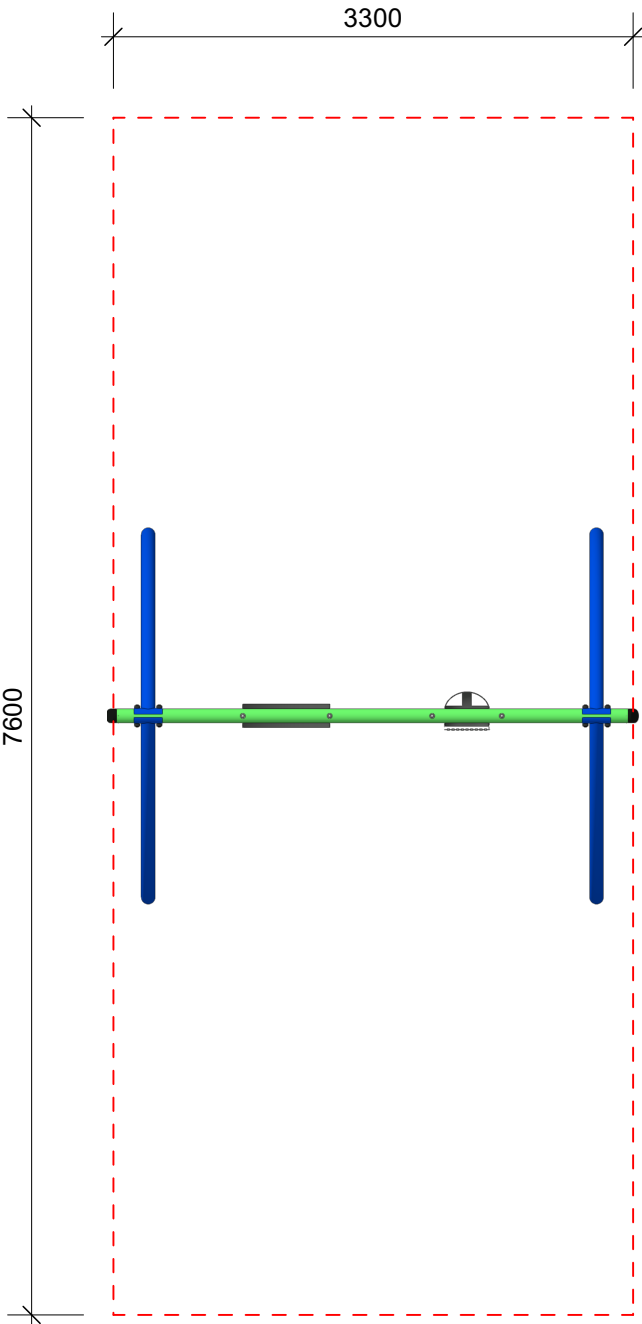

25 YEAR
WARRANTY

for structural
H5 timber and
galvanized
steel posts



15 YEAR
WARRANTY

for stainless
steel fasteners
and galvanized
chain



10 YEAR
WARRANTY

for the integrity of
moulded plastics,
Polyplay plastic
panel and metal
powder coating



2 YEAR
WARRANTY

for moving
components
and replaceable
wearing parts

PRODUCT
WARRANTY

Park Supplies & Playgrounds
warrant all products to be free
from manufacturing and
installation defects.

Disclaimer: this document should
be read in conjunction with Park
Supplies & Playgrounds full
warranty terms and conditions.

PARK SUPPLIES & PLAYGROUNDS

PO Box 59017
Mangere Bridge 2151
PH: 0800 752 947
PH: 09 527 4666
EM: SALES@PARKSUPPLIES.CO.NZ
W: www.parksupplies.co.nz

COPYRIGHT NOTICE:

Any copying (including photocopying or electronic storage) of any part of this document without prior written consent from Park Supplies & Playgrounds is an infringement of copyright.
NOTE: Our company is continually refining and improving our products. We reserve the right to alter/modify any of our products design without prior notice. CAD drawings are INDICATIVE ONLY.
Activities are designed and manufactured in accordance with the NZS5828:2015

